



<p>Breckland Council</p>  <p>Elizabeth House Walpole Loke Dereham NR19 1EE</p> <p>Tel. 01362 656870 - Fax. 01362 656297</p>	<p>Title</p> <p>PLAY AREA BERGAMOT CLOSE THETFORD</p>	 <p>Scale 1:500</p>	<p>Date</p> <p>Oct 2016</p>	
	<p>Project / Details</p> <p>SITE PLAN</p>		<p>Drawn by / Department</p> <p>???</p>	
			<p>Drawing / Reference Number</p> <p>???</p>	



Breckland Council
 Elizabeth House
 Walspole Lake
 Dereham
 NR19 1EE
 Breckland
 Tel: 01382 888870 - Fax: 01382 888237

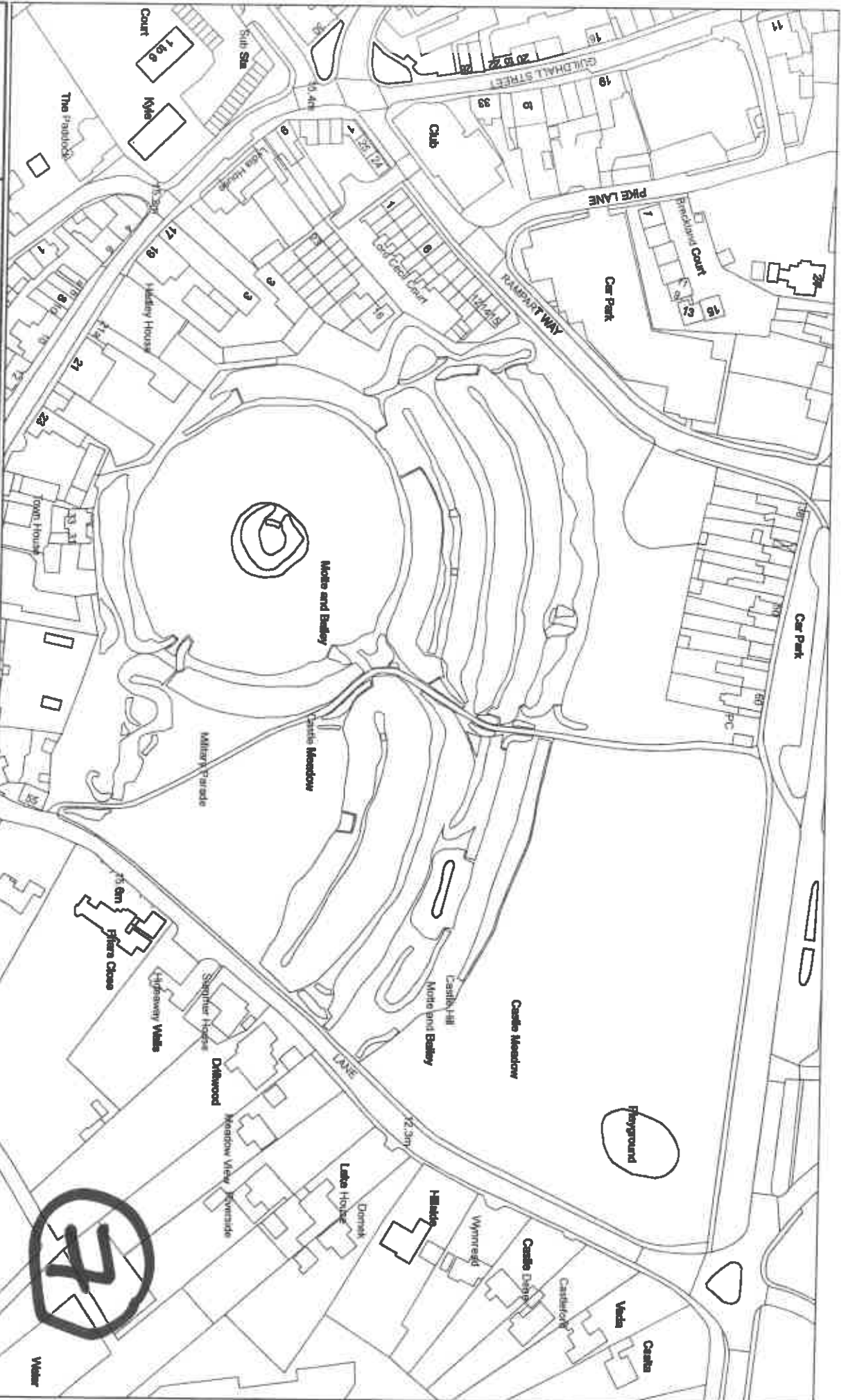

**CASTLE ROUND
 THETFORD**
 The
 Project / Details
SITE PLAN

Scale	1:1,250
Date	Oct 2016
Drawn by / Department	777
Checking / Reference Number	777

Copyright:
 This map is reproduced from Ordnance Survey material with the permission of Crown Copyright and the Controller of Her Majesty's Stationery Office & Crown Copyright. Unauthorised reproduction is illegal. Crown copyright and may be reproduced in whole or in part by any person without the permission of the Controller of Her Majesty's Stationery Office & Crown Copyright. Published 2005.

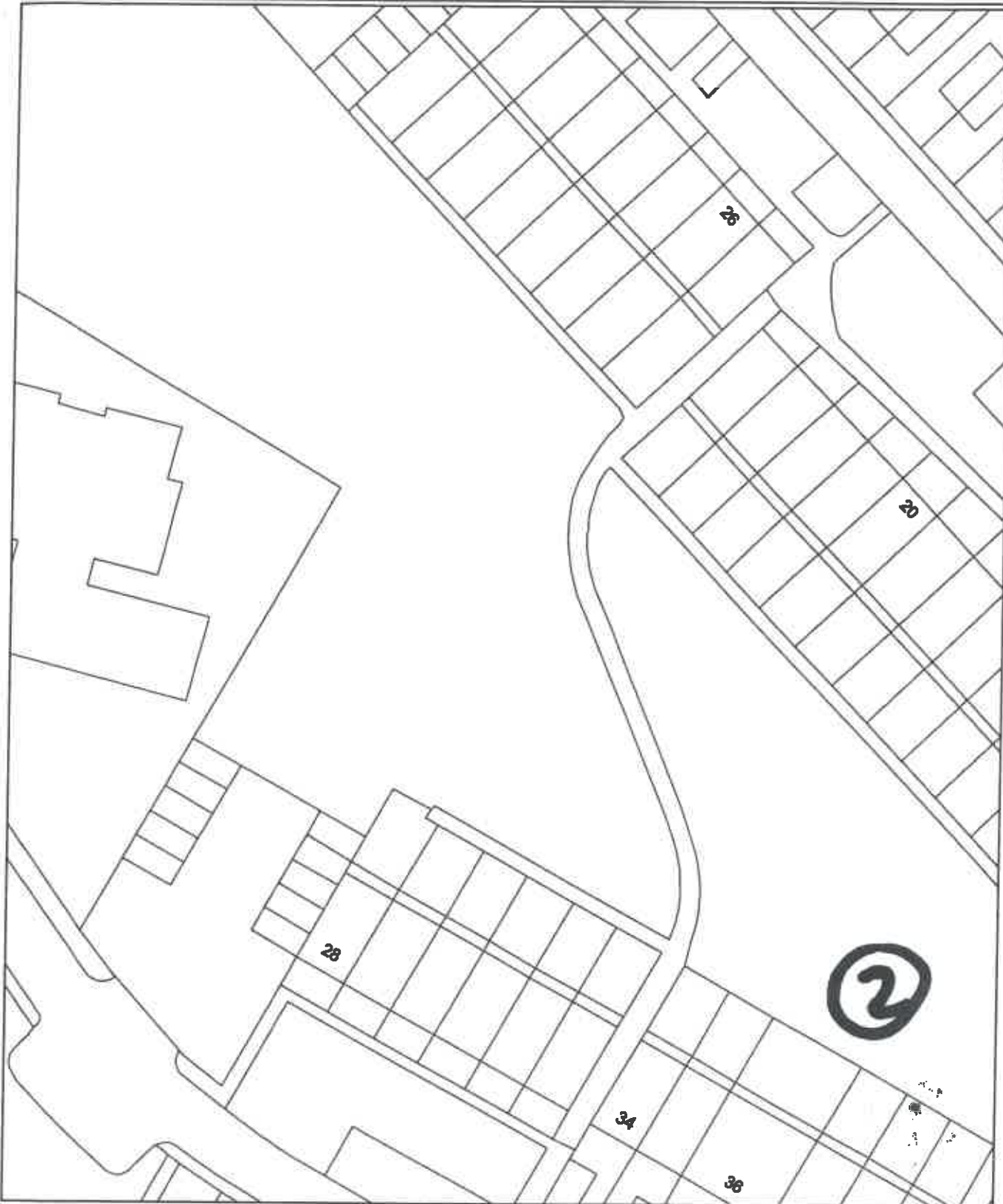
This map is reproduced from Ordnance Survey material with the permission of Ordnance Survey on behalf of the Controller of Her Majesty's Stationary Office © Crown copyright. Unauthorised reproduction infringes Crown copyright and may lead to prosecution or civil proceedings. Breckland District Council licence no.100010535. Published 2005.



Breckland Council  Elizabeth House Walpole Loke Dereham NR19 1EE Breckland Tel. 01362 656870 - Fax. 01362 656297	Title PLAY AREA EDINBURGH WAY THETFORD		Scale 1:500	
	Project / Details SITE PLAN		Date Oct 2016	
		Drawn by / Department ???		
		Drawing / Reference Number ???		

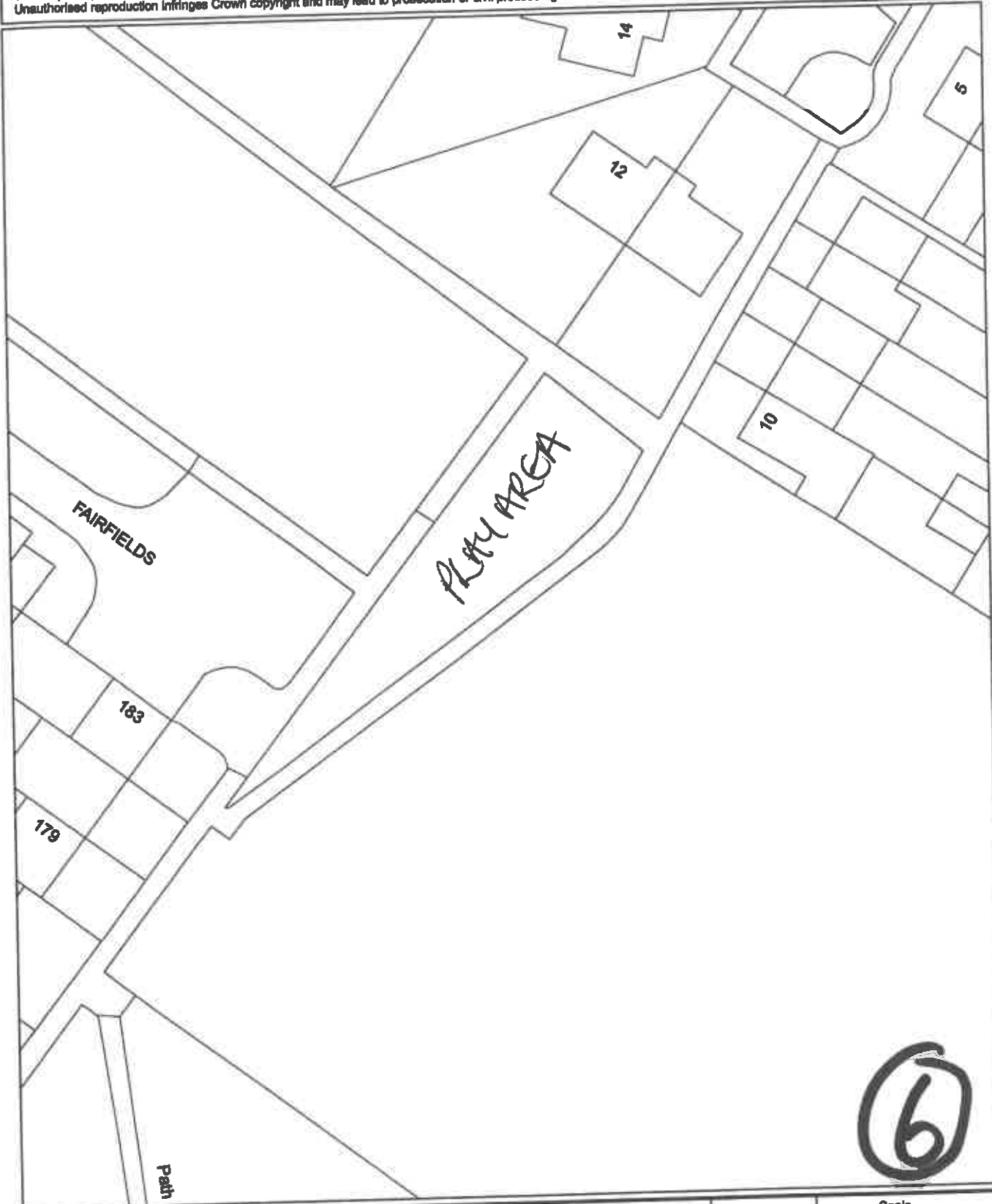

⑥

<p>Breckland Council</p>  <p>Elizabeth House Walpole Loke Dereham NR19 1EE</p> <p>Breckland</p> <p>Tel. 01362 656870 - Fax. 01362 656297</p>	<p>Title</p> <p>PLAY AREA FAIRFIELDS THETFORD</p>	<p>Scale</p> <p>1:500</p>
	<p>Project / Details</p> <p>SITE PLAN</p>	
		<p>Drawn by / Department</p> <p>???</p>
		<p>Drawing / Reference Number</p> <p>???</p>

This map is reproduced from Ordnance Survey material with the permission of Ordnance Survey on behalf of the Controller of Her Majesty's Stationery Office © Crown copyright. Unauthorised reproduction infringes Crown copyright and may lead to prosecution or civil proceedings. Breckland District Council License no. 100018335, Published 2011.

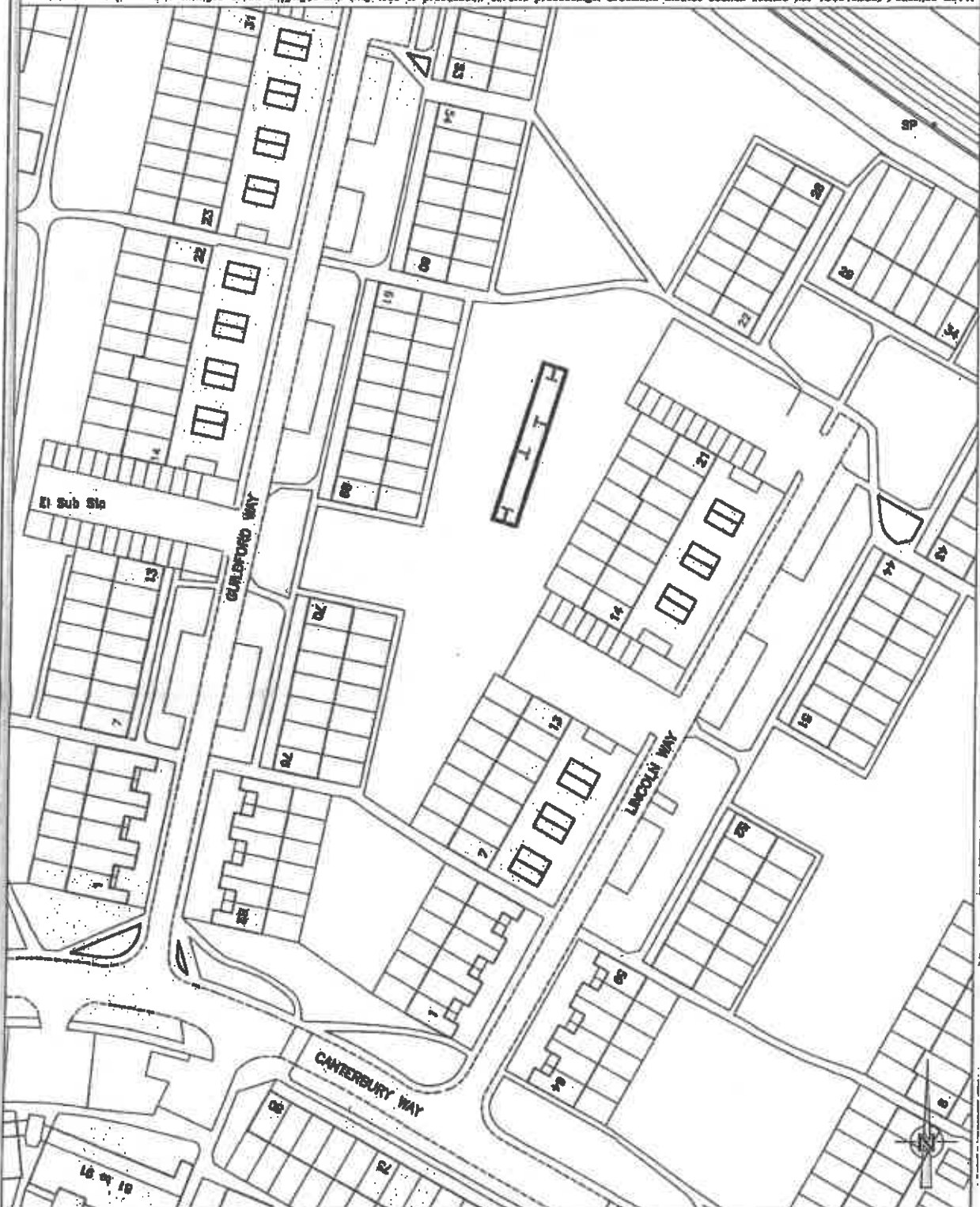

Asset Management
 Elizabeth House
 Walpole Lake
 Dereham
 Norfolk
 NR16 1EE

Breckland Council
a little place, a big life from

Tel: 01328 656870 Fax: 01328 896877

TITLE
**PLAY AREA AT
 GUILDFORD WAY
 THETFORD**



DRAWING DETAILS

TRANSFER PLAN

© This drawing and the works depicted thereon are the copyright of Breckland District Council. Unauthorised reproduction infringes copyright.

PRODUCED BY	DATE	SCALE
PRD	June 2014	1:1000
DRAWING No.		Rev.
D67T1		E181 A



Breckland Council  Elizabeth House Walpole Loke Dereham NR19 1EE Tel. 01362 656870 - Fax. 01362 656297	Title PLAY AREA HARRIET MARTINEAU CLOSE THETFORD	 Scale 1:500 Date Oct 2016
	Project / Details SITE PLAN	
		Drawing / Reference Number ???

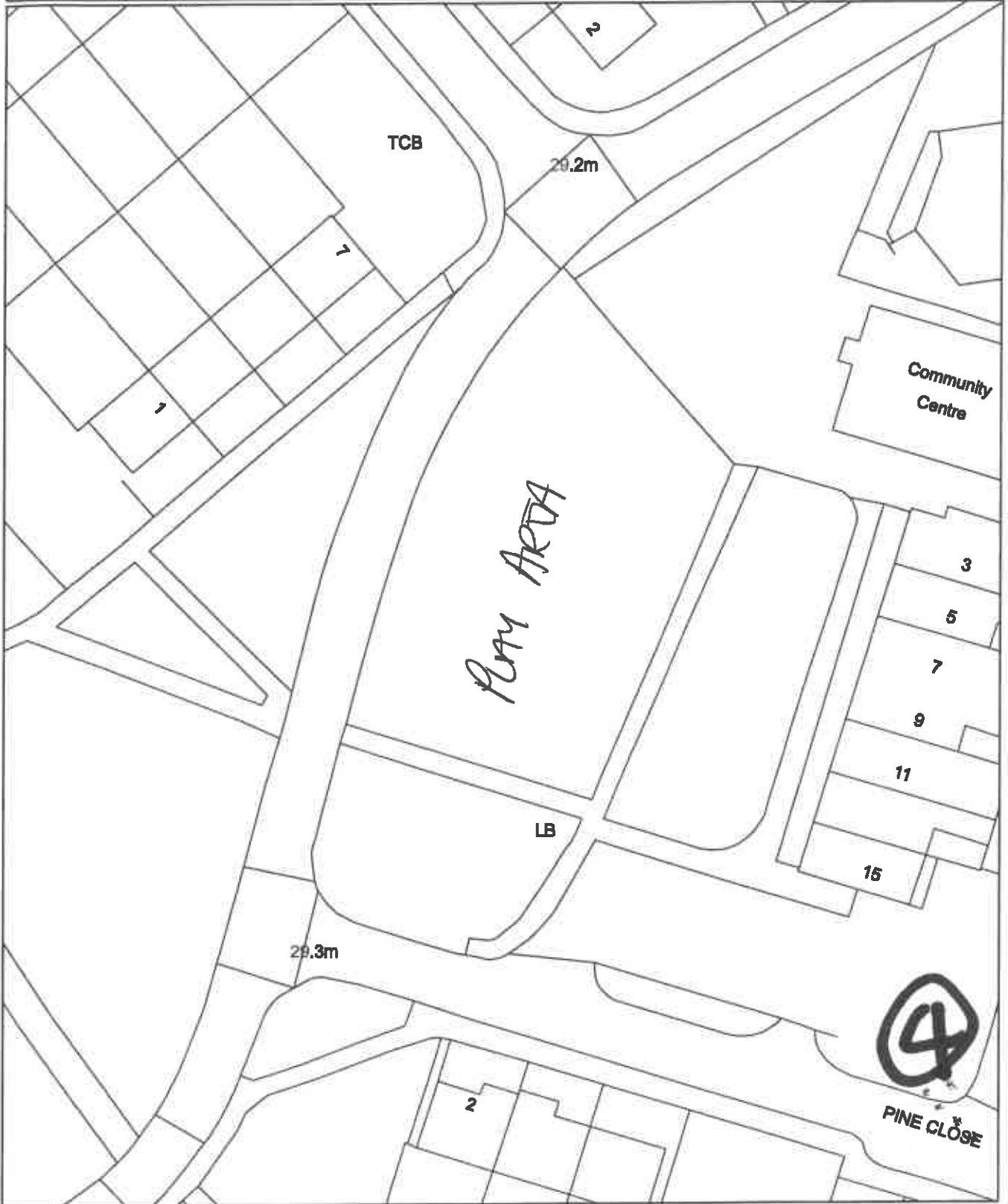

<p>Breckland Council</p>  <p>Elizabeth House Walpole Loke Dereham NR19 1EE</p> <p>Breckland</p> <p>Tel. 01362 656870 - Fax. 01362 656297</p>	<p>Title</p> <p>PLAY AREA PINE CLOSE THETFORD</p>	<p>Scale</p> <p>1:500</p>
	<p>Project / Details</p> <p>SITE PLAN</p>	<p>Date</p> <p>Oct 2016</p>
	<p>Drawn by / Department</p> <p>???</p>	<p>Drawing / Reference Number</p> <p>???</p>

This drawing and the works depicted thereon are the copyright of Breckland District Council. Unauthorised reproduction infringes copyright.



NOTES

Open Space Areas

Total of Three Red Line Areas = 7334 sq m
 Total Area of Fenced Play Areas = 637 sq m
 Proportion of Play Areas = $\frac{637}{7334} \times 100 = 8.7\%$

AMENDMENTS

REF	DATE	DETAILS



Asset Management
 Elizabeth House
 Walpole Lake
 Dereham
 Norfolk
 NR19 1EE

Breckland
 COUNCIL

Tel: 01362 656870 Fax: 01362 656877

